

PLAN
SCALE - 1:5000

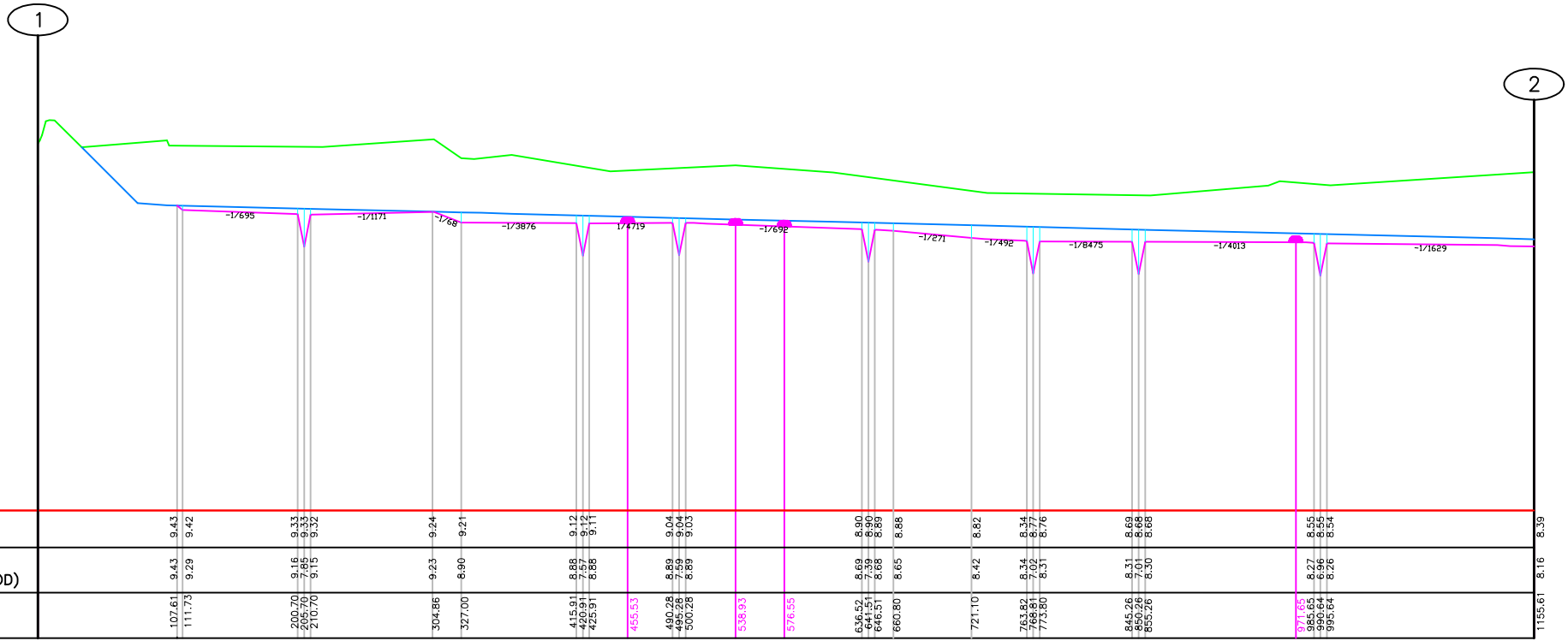

SECTION 1 - 2
SCALE - HORZ: 1:5000
VERT: 1:200

NOTES

Levels are in meters O.D. and refer to Ordnance Datum Malin Head.

Chainages are in meters.

Proposed mitigation works are indicative and subject to change following initial dredging.

Legend

Existing Bed Level

Proposed Bed Level

Proposed Thalweg Invert Level

Proposed Thalweg (Plan)

Proposed Full Channel Width Rubble Mat (Plan)

Proposed Half Channel Width Rubble Mat (Plan)

Proposed Pool (Plan)

Thalweg to be lined at the base with large rounded cobbles and generally to have a width of 10m. (See indicative section B-B, Drawing No. 003)

Thalweg to have a width of 5m between chainages 1630m and 2450m. (See indicative section A-A, Drawing No. 002)

Pools to be approximately 15m long with imported gravels at the tail

Rubble mats to be approximately 12m long and 0.3m high

Figure 5.5

A	06/06/12	OC	POOLS DEEPEINED TO 1.3m	CL	-
REV	DATE	DRN	DESCRIPTION	CHK	APD
REVISIONS					

Copyright Ryan Hanley
This drawing must not be reproduced in any form without the prior written consent of Ryan Hanley consulting engineers

DRAWING STATUS		
<input type="checkbox"/> PRELIMINARY	<input type="checkbox"/> CONTRACT	<input type="checkbox"/> TENDER
<input type="checkbox"/> PLANNING	<input type="checkbox"/> CONSTRUCTION	<input type="checkbox"/> FOR APPROVAL
<input type="checkbox"/> FOR YOUR INFORMATION	<input type="checkbox"/> AS CONSTRUCTED	<input checked="" type="checkbox"/> DRAFT

RYAN HANLEY
CONSULTING ENGINEERS

Sherwood House, Sherwood Avenue
Taylor's Hill, Galway
Tel: (091) 587116 Fax: (091) 587110
Email: rhc@ryanhaley.ie
Web: www.ryanhaley.ie

DUBLIN OFFICE: Suite D4, The Cubes Offices, Beacon South Quarter, Sandyford, Dublin18.

CLIENT
OFFICE OF PUBLIC WORKS

PROJECT
**BANDON FLOOD RELIEF SCHEME
FISHERIES MITIGATION DESIGN**

TITLE
**LAYOUT PLAN AND LONGITUDINAL
SECTION OF PROPOSED FISHERIES
MITIGATION MEASURES**

SCALE @ A3 HORZ: 1:5000 VERT: 1:200	DATE May 2012	DRAWN OC	CHECKED CL	APPROVED -
JOB No. 2185	DRAWING No. 001	REV.		

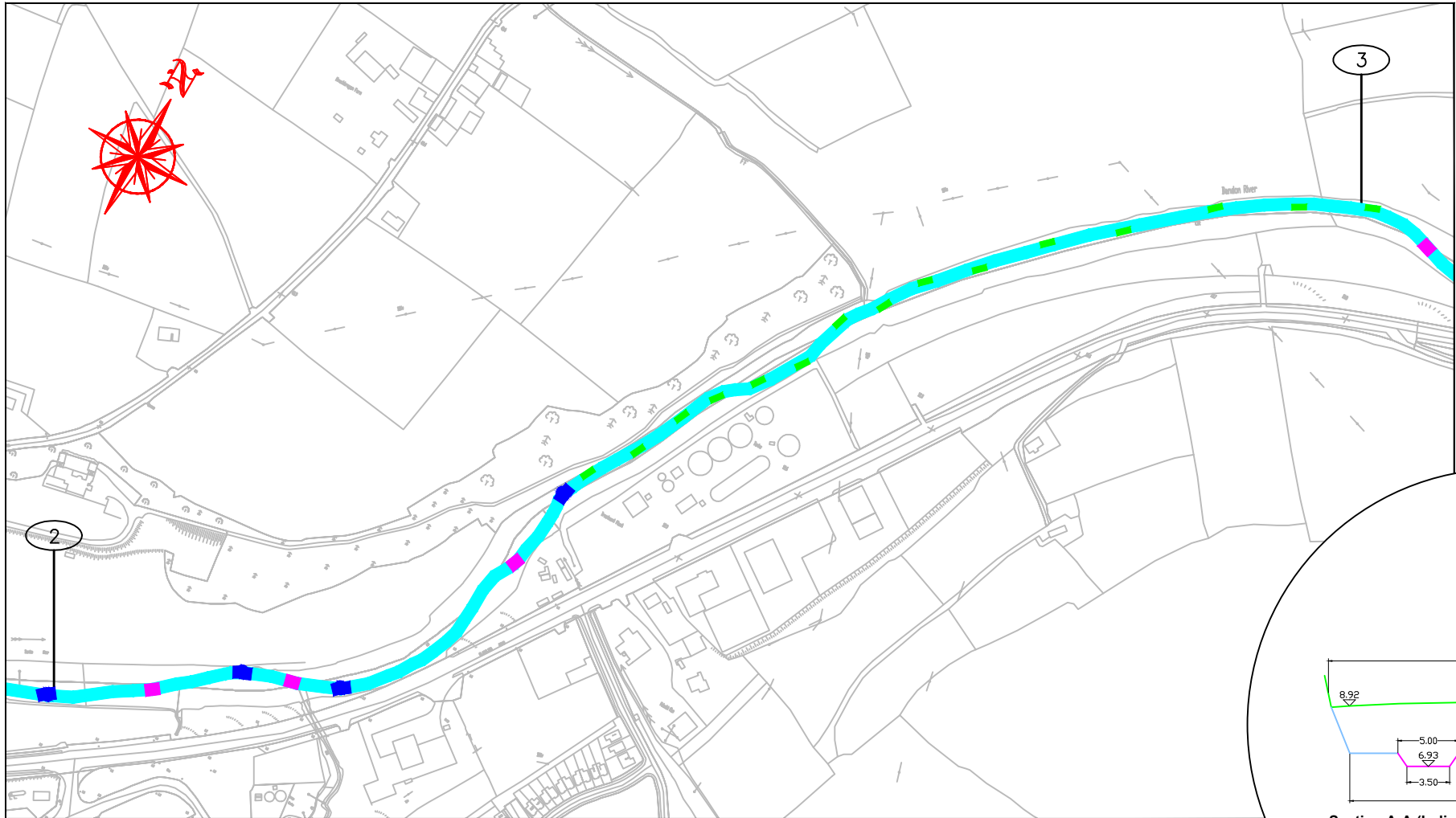

PLAN
SCALE - 1:5000

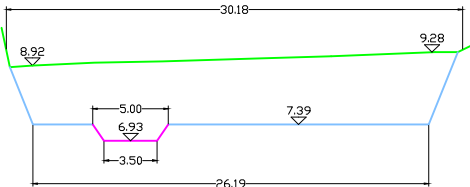

Section A-A (Indicative)
SCALE - HORZ: 1:500
VERT: 1:200

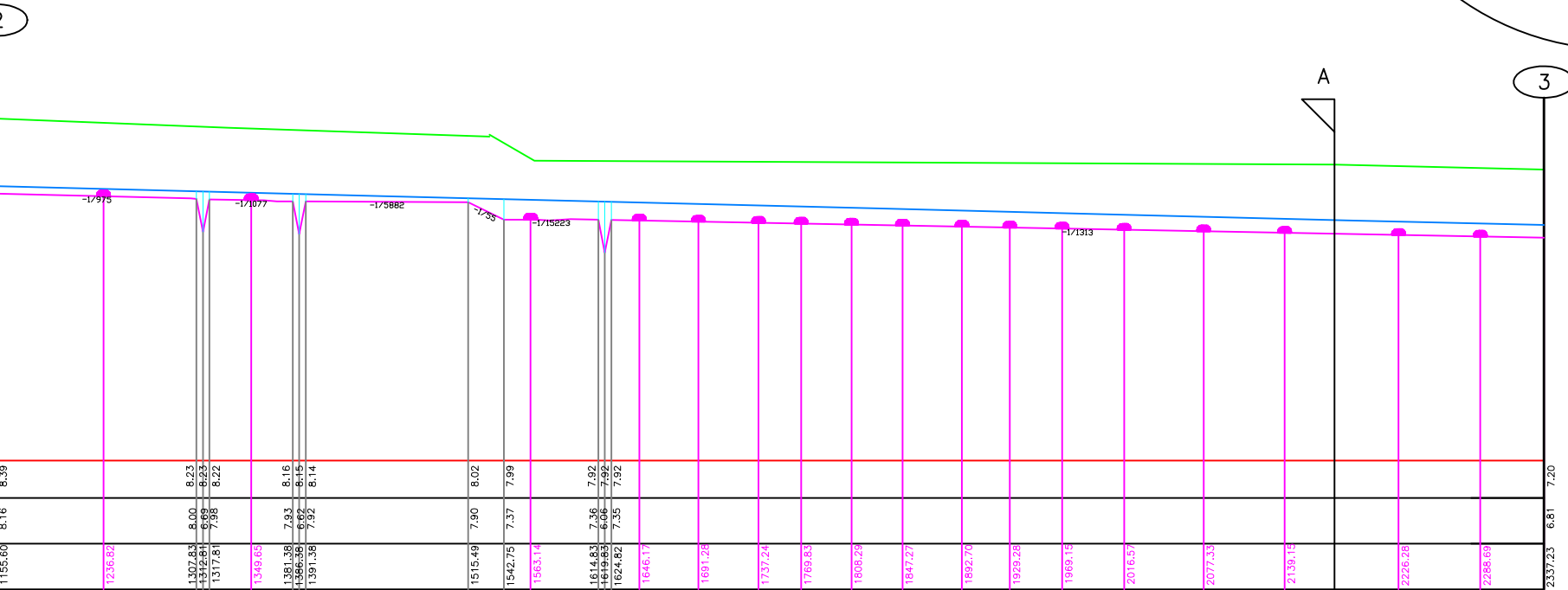

SECTION 2 - 3
SCALE - HORZ: 1:5000
VERT: 1:200

NOTES

Levels are in meters O.D. and refer to Ordnance Datum Malin Head.

Chainages are in meters.

Proposed mitigation works are indicative and subject to change following initial dredging.

Legend

Existing Bed Level

Proposed Bed Level

Proposed Thalweg Invert Level

Proposed Thalweg (Plan)

Proposed Full Channel Width Rubble Mat (Plan)

Proposed Half Channel Width Rubble Mat (Plan)

Proposed Pool (Plan)

Thalweg to be lined at the base with large rounded cobbles and generally to have a width of 10m. (See indicative section B-B, Drawing No. 003)

Thalweg to have a width of 5m between chainages 1630m and 2450m. (See indicative section A-A, Drawing No. 002)

Pools to be approximately 15m long with imported gravels at the tail

Rubble mats to be approximately 12m long and 0.3m high

Figure 5.6

A	06/06/12	OC	POOLS DEEPEENED TO 1.3m	CL	-
REV	DATE	DRN	DESCRIPTION	CHK	APD
REVISIONS					

Copyright Ryan Hanley
This drawing must not be reproduced in any form without the prior written consent of Ryan Hanley consulting engineers

DRAWING STATUS		
<input type="checkbox"/> PRELIMINARY	<input type="checkbox"/> CONTRACT	<input type="checkbox"/> TENDER
<input type="checkbox"/> PLANNING	<input type="checkbox"/> CONSTRUCTION	<input type="checkbox"/> FOR APPROVAL
<input type="checkbox"/> FOR YOUR INFORMATION	<input type="checkbox"/> AS CONSTRUCTED	<input checked="" type="checkbox"/> DRAFT

RYAN HANLEY

CONSULTING ENGINEERS

Sherwood House, Sherwood Avenue

Taylor's Hill, Galway

Tel: (091)587116 Fax: (091)587110

Email: rhc@ryanhaley.ie

Web: www.ryanhaley.ie

DUBLIN OFFICE: Suite D4, The Cubes Offices, Beacon South Quarter, Sandyford, Dublin18.

CLIENT
OFFICE OF PUBLIC WORKS

PROJECT
BANDON FLOOD RELIEF SCHEME
FISHERIES MITIGATION DESIGN

TITLE
LAYOUT PLAN AND LONGITUDINAL
SECTION OF PROPOSED FISHERIES
MITIGATION MEASURES

SCALE @ A3 AS SHOWN	DATE May 2012	DRAWN OC	CHECKED CL	APPROVED -
JOB No. 2185	DRAWING No. 002	REV.		

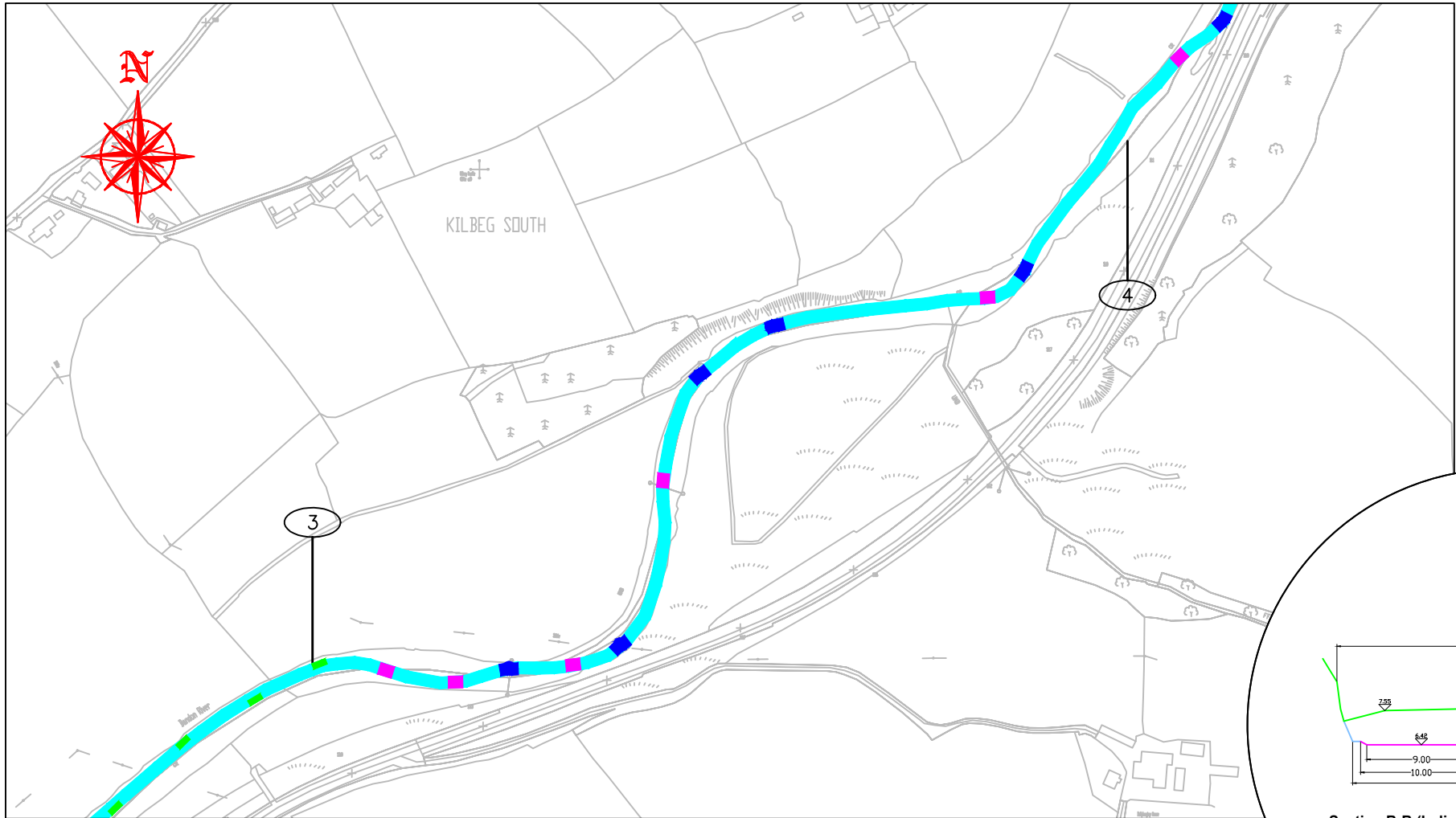

PLAN
SCALE - 1:5000

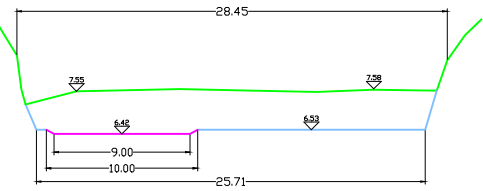

Section B-B (Indicative)
SCALE - HORZ: 1:500
VERT: 1:200

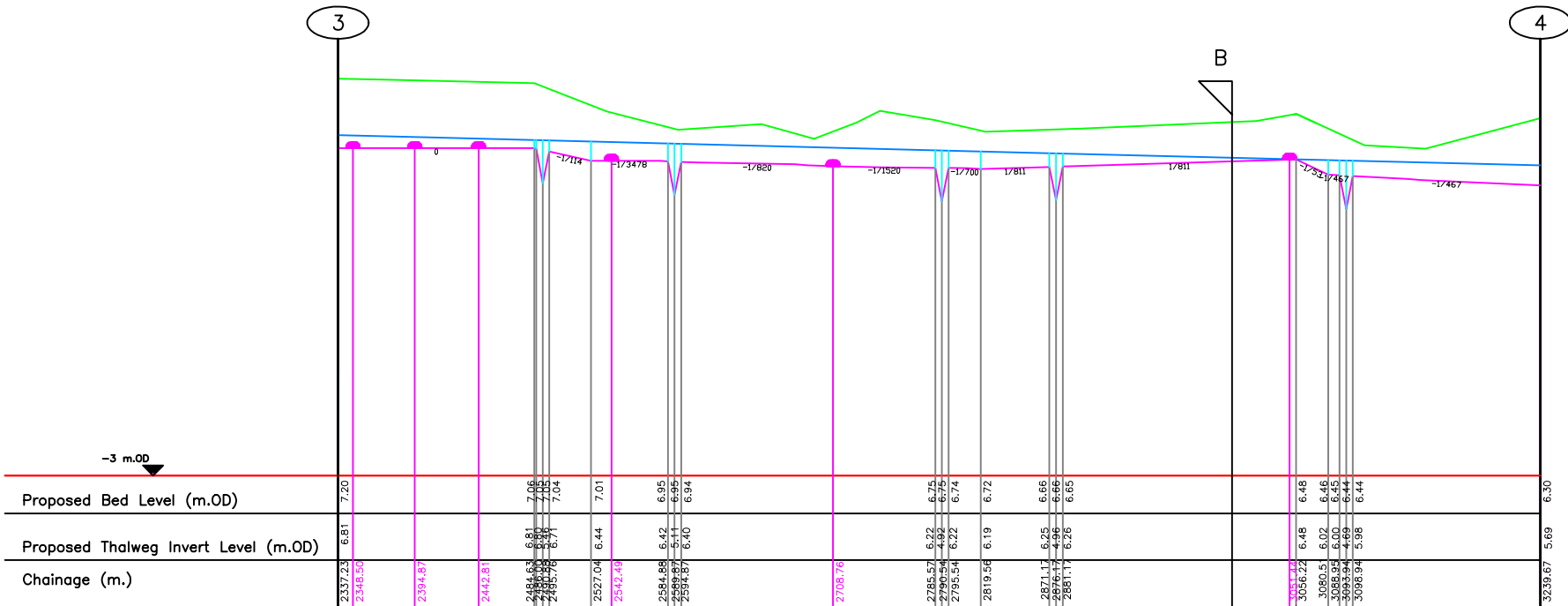

SECTION 3 - 4
SCALE - HORZ: 1:5000
VERT: 1:200

NOTES

Levels are in meters O.D. and refer to Ordnance Datum Malin Head.

Chainages are in meters.

Proposed mitigation works are indicative and subject to change following initial dredging.

Legend

Existing Bed Level

Proposed Bed Level

Proposed Thalweg Invert Level

Proposed Thalweg (Plan)

Proposed Full Channel Width Rubble Mat (Plan)

Proposed Half Channel Width Rubble Mat (Plan)

Proposed Pool (Plan)

Thalweg to be lined at the base with large rounded cobbles and generally to have a width of 10m. (See indicative section B-B, Drawing No. 003)

Thalweg to have a width of 5m between chainages 1630m and 2450m. (See indicative section A-A, Drawing No. 002)

Pools to be approximately 15m long with imported gravels at the tail

Rubble mats to be approximately 12m long and 0.3m high

Figure 5.7

REV	DATE	DRN	DESCRIPTION	CHK	APD
A	06/06/12	OC	POOLS DEEPEENED TO 1.3m	CL	-

REVISIONS					
Copyright Ryan Hanley This drawing must not be reproduced in any form without the prior written consent of Ryan Hanley consulting engineers					
DRAWING STATUS					
<input type="checkbox"/> PRELIMINARY	<input type="checkbox"/> CONTRACT	<input type="checkbox"/> TENDER			
<input type="checkbox"/> PLANNING	<input type="checkbox"/> CONSTRUCTION	<input type="checkbox"/> FOR APPROVAL			
<input type="checkbox"/> FOR YOUR INFORMATION	<input type="checkbox"/> AS CONSTRUCTED	<input checked="" type="checkbox"/> DRAFT			

RYAN HANLEY

CONSULTING ENGINEERS

Sherwood House, Sherwood Avenue
Taylor's Hill, Galway
Tel: (091) 587116 Fax: (091) 587110
Email: rhc@ryanhlanley.ie
Web: www.ryanhlanley.ie

DUBLIN OFFICE: Suite D4, The Cubes Offices, Beacon South Quarter, Sandyford, Dublin18.

CLIENT
OFFICE OF PUBLIC WORKS

PROJECT
**BANDON FLOOD RELIEF SCHEME
FISHERIES MITIGATION DESIGN**

TITLE
**LAYOUT PLAN AND LONGITUDINAL
SECTION OF PROPOSED FISHERIES
MITIGATION MEASURES**

SCALE @ A3 AS SHOWN	DATE May 2012	DRAWN OC	CHECKED CL	APPROVED -
JOB No. 2185	DRAWING No. 003	REV.		

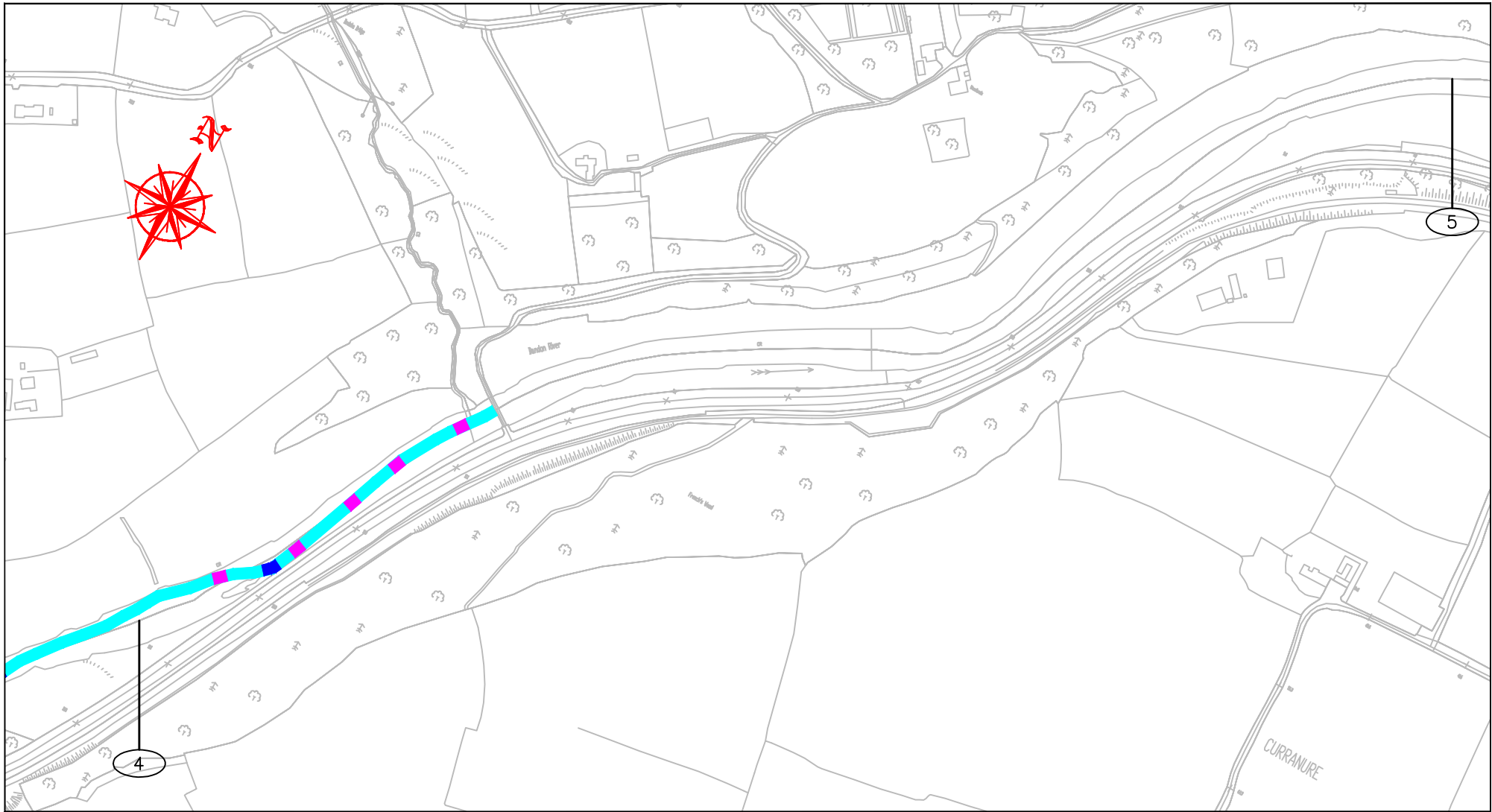

PLAN
SCALE - 1:5000

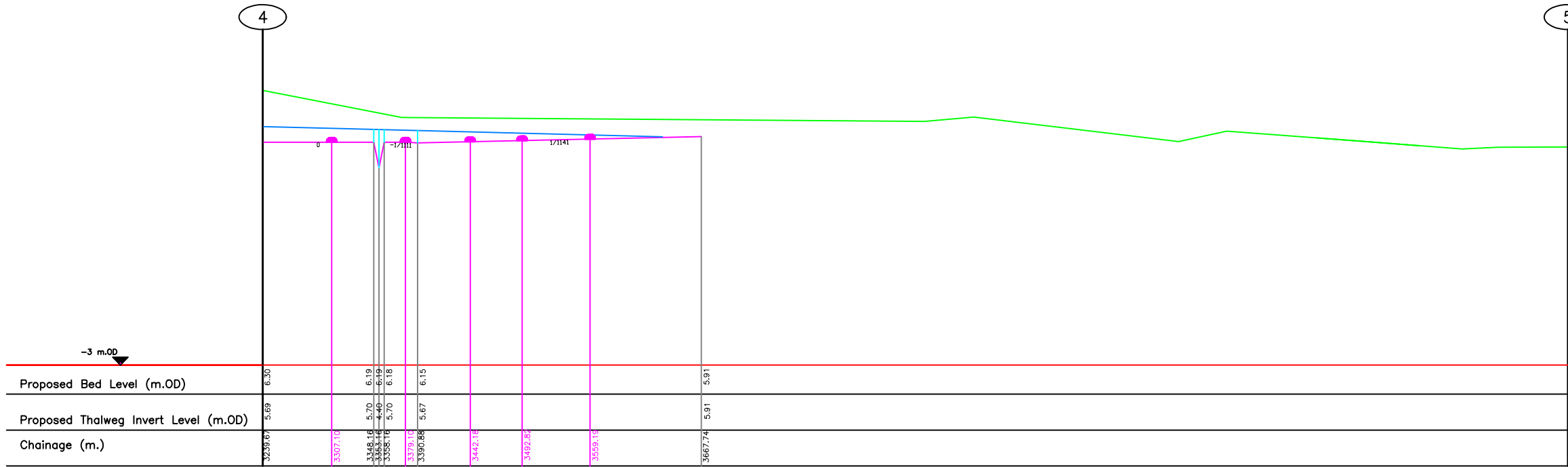

SECTION 4 - 5
SCALE - HORZ: 1:5000
VERT: 1:200

NOTES

Levels are in meters O.D. and refer to Ordnance Datum Malin Head.

Chainages are in meters.

Proposed mitigation works are indicative and subject to change following initial dredging.

Legend

Existing Bed Level

Proposed Bed Level

Proposed Thalweg Invert Level

Proposed Thalweg (Plan)

Proposed Full Channel Width Rubble Mat (Plan)

Proposed Half Channel Width Rubble Mat (Plan)

Proposed Pool (Plan)

Thalweg to be lined at the base with large rounded cobbles and generally to have a width of 10m. (See indicative section B-B, Drawing No. 003)

Thalweg to have a width of 5m between chainages 1630m and 2450m. (See indicative section A-A, Drawing No. 002)

Pools to be approximately 15m long with imported gravels at the tail

Rubble mats to be approximately 12m long and 0.3m high

Figure 5.8

A	06/06/12	OC	POOLS DEEPEENED TO 1.3m	CL	-
REV	DATE	DRN	DESCRIPTION	CHK	APD

REVISIONS					
Copyright Ryan Hanley This drawing must not be reproduced in any form without the prior written consent of Ryan Hanley consulting engineers					
DRAWING STATUS					
<input type="checkbox"/> PRELIMINARY	<input type="checkbox"/> CONTRACT	<input type="checkbox"/> TENDER			
<input type="checkbox"/> PLANNING	<input type="checkbox"/> CONSTRUCTION	<input type="checkbox"/> FOR APPROVAL			
<input type="checkbox"/> FOR YOUR INFORMATION	<input type="checkbox"/> AS CONSTRUCTED	<input checked="" type="checkbox"/> DRAFT			

RYAN HANLEY

CONSULTING ENGINEERS

Sherwood House, Sherwood Avenue
Taylor's Hill, Galway

Tel: (091)587116 Fax: (091)587110
Email: rhc@ryanhanely.ie
Web: www.ryanhanely.ie

DUBLIN OFFICE: Suite D4, The Cubes Offices, Beacon South Quarter, Sandyford, Dublin18.

CLIENT
OFFICE OF PUBLIC WORKS

PROJECT
BANDON FLOOD RELIEF SCHEME
FISHERIES MITIGATION DESIGN

TITLE
LAYOUT PLAN AND LONGITUDINAL
SECTION OF PROPOSED FISHERIES
MITIGATION MEASURES

SCALE @ A3 HORZ: 1:5000 VERT: 1:200	DATE May 2012	DRAWN OC	CHECKED CL	APPROVED -
JOB No. 2185	DRAWING No. 004	REV.		