

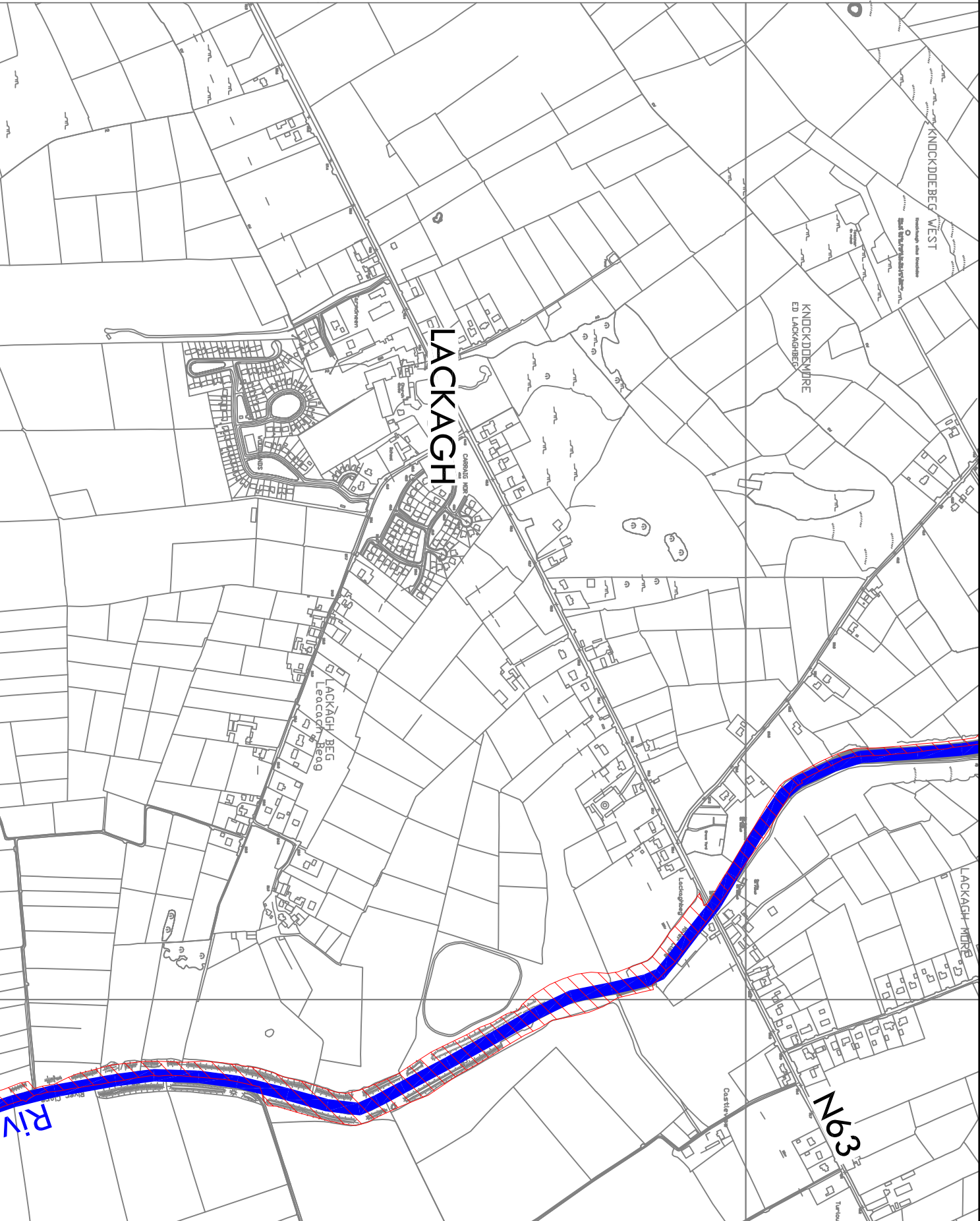

APPENDIX C OUTLINE DESIGN OF POTENTIALLY VIABLE MEASURES

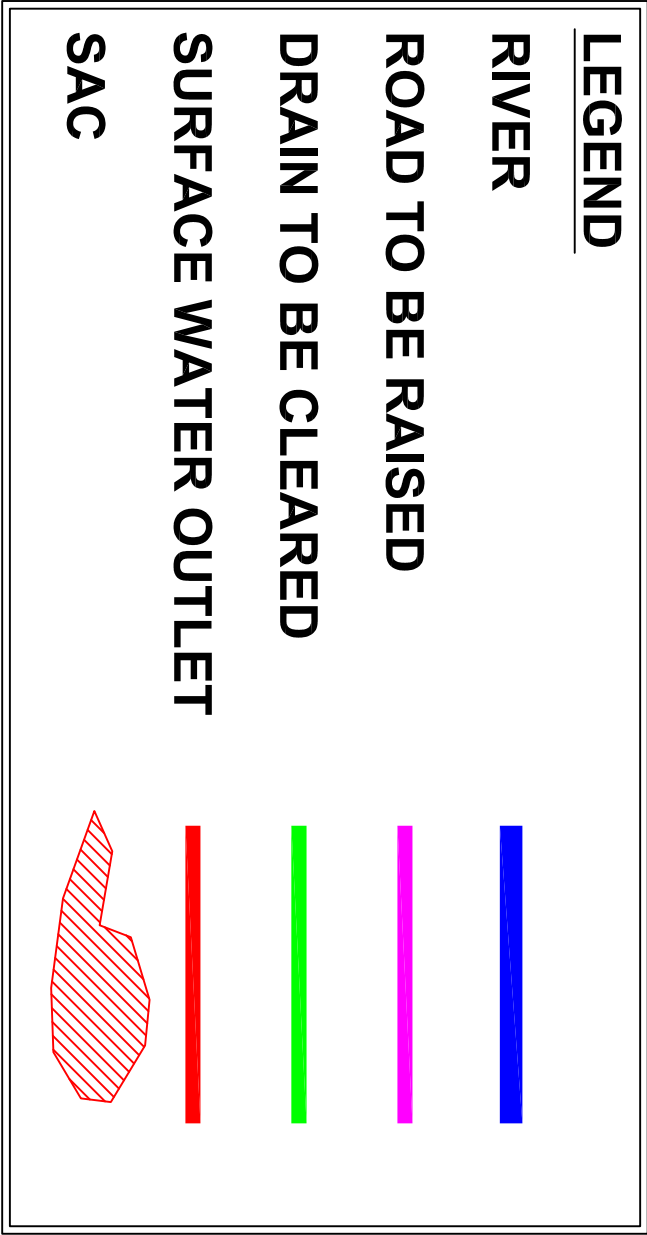

- 2b. Increase size of culvert in conjunction with road works
- 2c. Clean drain ED at Mollath and other drains in vicinity
- 3a. Raise access road
- 4a. Install additional flood eye at Clargewally Bridge
- 4b. Regrade channel upstream of and under Clargewally Bridge
- 4c. Fill up in flood defense wall at A1 Mainshill housing settlement
- 4d. Provide local enhancement at Old Nine Arches bridge
- 5a. Improve C37
- 5b. Provide stream C3/5
- 6a. Clean surface water outlet through fields and along M17 to downstream of Clargewally Bridge
- 6b. Install additional flood eyes at Craighern Bridge
- 7a. Clean up drain from 300m upstream of Craighern Bridge to Clargewally
- 8c. Cleaning and regrading of Islandmore drain OPW C3/7 & F.739/1
- 10a. Raise local road
- 10b. Replace existing flood bridge with wider bridge
- 10c. Replace existing flood bridge with bridge to Bultinn Bridge
- 11a. Re-grading from A7 to A16
- 12a. Install additional flood eye at Bultinn Bridge
- 13a. Channel widening

SCALE @ A1	DATE	DRAWN	CHECKED	APPROVED
1:10,000	JUNE 2010	R.K.	C.L.	M.J.
JOB No.	DRAWING No.		REV.	
2138	500			

RYAN HANLEY

CONSULTING ENGINEERS

Sherwood House, Sherwood Avenue
Taylor's Hill, Galway

Tel:(091)587116 Fax:(091)587110
Email: rhc@ryanhanley.ie
Web: www.ryanhanley.ie

DUBLIN Office: Suite D4, The Cubes Office, South Quarter, Sandyford, Dublin 18.

CLIENT

Office of Public Works

Copyright Ryan Hanley
This drawing must not be reproduced in any form without the prior written consent of Ryan Hanley consulting engineers

REV	DATE	DRN	DESCRIPTION	CHK	APD
REVISIONS					

DRAWING STATUS

☐ PRELIMINARY

☐ PLANNING

☒ FOR YOUR INFORMATION

☐ CONTRACT

☐ CONSTRUCTION

☐ AS CONSTRUCTED

☐ TENDER

☐ FOR APPROVAL

☐ DRAFT

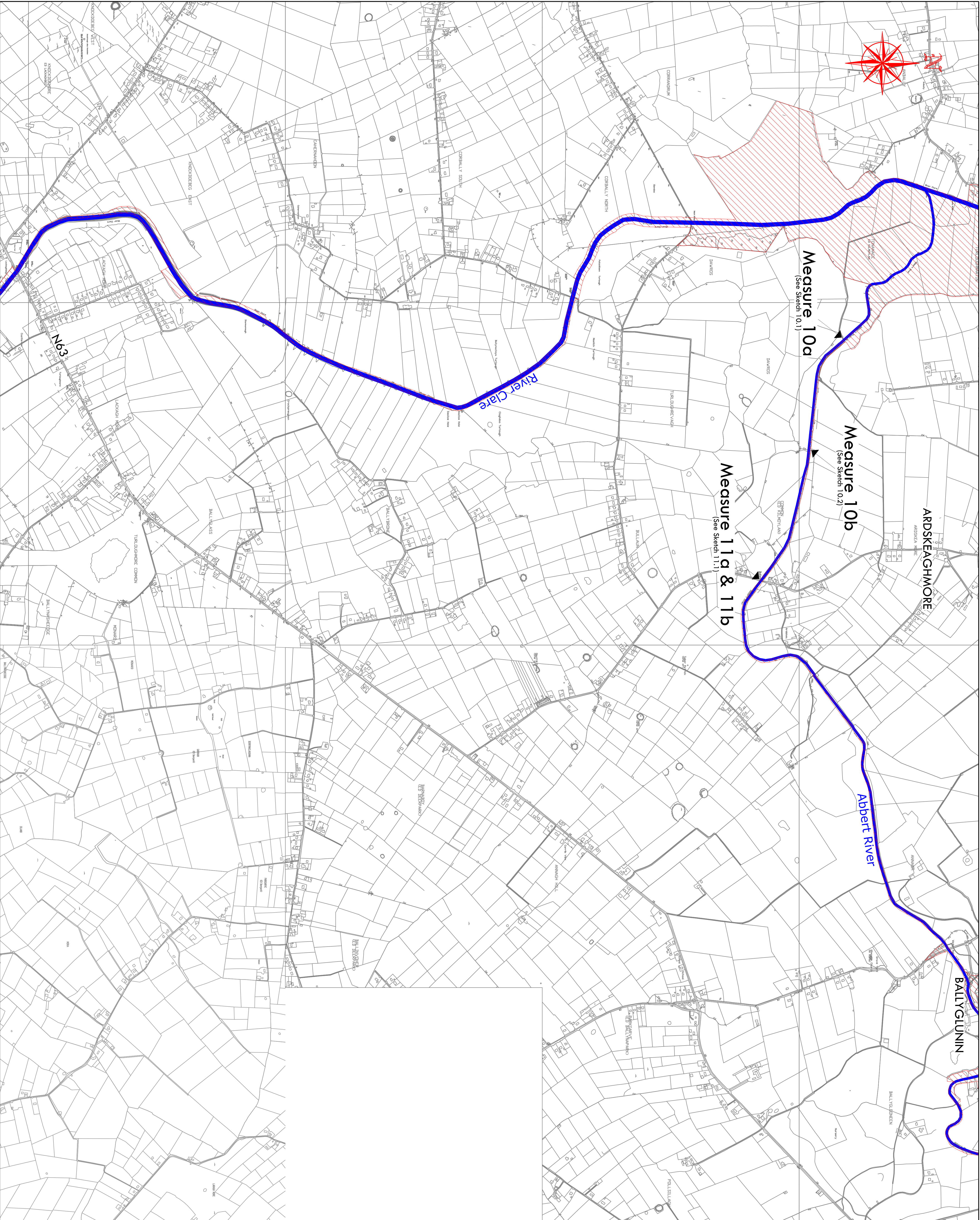

NOTES

FLOOD ALLEVIATION MEASURES

- 2a. Raise access road
- 2b. Clean drain ED @ Mientach and other drains in vicinity
- 3a. Raise access road
- 3b. Raise access road
- 4a. Install additional flood eye at Claregalway Bridge
- 4b. Install additional flood eye at Claregalway Bridge
- 4c. Fill gap in flood defence wall at An Mhaisistir housing estate
- 4d. Provide local embankment at old Nine Arches bridge
- 5a. Increase capacity of at least one culvert on stream
- 5b. Clean stream C3/5
- 6a. Provide surface water outlet through fields and along N17
- 6b. Install additional flood eyes at Crusheen Bridge
- 6c. Clean drain ED @ Crusheen Bridge
- 6d. Clean drain ED @ Crusheen Bridge
- 6e. Cleaning and regrading of Islandmore drain OPW C3/7 & F/7/9/1
- 8d. Re-align road
- 10a. Replace existing field bridge with wider bridge
- 10b. Channel widening from field bridge to Bullaun Bridge
- 10c. Re-grading from A7 to A16
- 11a. Install additional flood eye at Bullaun Bridge
- 11b. Channel widening

LEGEND

RIVER

SAC

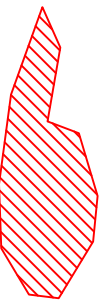

REV	DATE	DWN	DESCRIPTION	CHK	APP
REVISIONS					

Copyright Ryan Hanley
This drawing must not be reproduced in any form without the prior written permission of Ryan Hanley Consulting Engineers

DRAWING STATUS

- ☐ PRELIMINARY ☐ CONTACT ☐ TENDER
- ☐ PLANNING ☐ CONSTRUCTION ☐ FOR APPROVAL
- ☒ FOR YOUR INFORMATION ☐ AS CONSTRUCTED ☐ DRAFT

RYAN HANLEY
CONSULTING ENGINEERS

Sherwood House, Sherwood Avenue
Taylor's Hill, Galway
Tel:(091)987116 Fax:(091)987110
Email: rhc@ryanhaley.ie
Web: www.ryanhaley.ie

DUBLIN OFFICE: Suite 04, The Cube Office, Beacon South Quarter, Smockford Dublin18.

Office of Public Works

PROJECT

Clare River Flood Study

TITLE

Overview of Proposed Flood
Alleviation Measures
(Sheet 2 of 2)

SCALE @ A1	DATE	DRAWN	CHECKED	APPROVED
1:10,000	JUNE 2010	R.K.	C.L.	M.J.
JOB No.	DRAWING No.			REV.
2138	501			

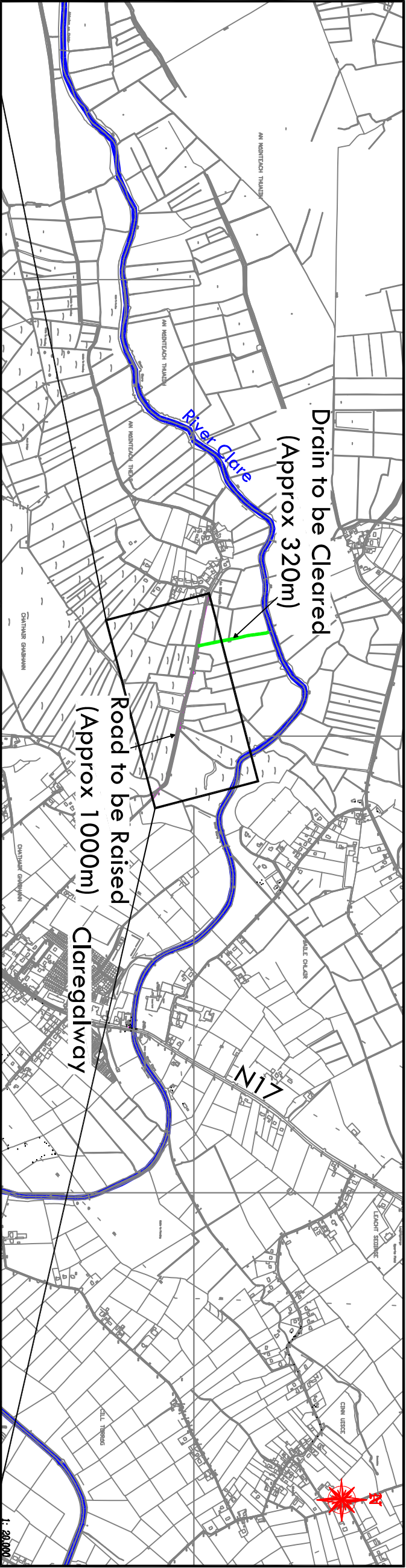

- NOTES**
- Note road has already been raised above field levels, with deep drains on either side. Health and Safety measures will need to be put in place, e.g. crash barriers.
 - Note that increasing the culvert capacity and clearing the drains will only assist in the conveyance of flows at mean flows and is unlikely to have a significant impact at high flows as lake will influence water level at that location.
 - Note that the stream drains to Clare River which is a cSAC and culvert works may require environmental mitigations.
 - Site of proposed culvert to be finalised at detailed design stage.

LEGEND

Road To Be Raised
7.78mOD

Drain To Be Cleared
7.73mOD

Existing Levels
7.73mOD

Proposed Levels
7.73mOD

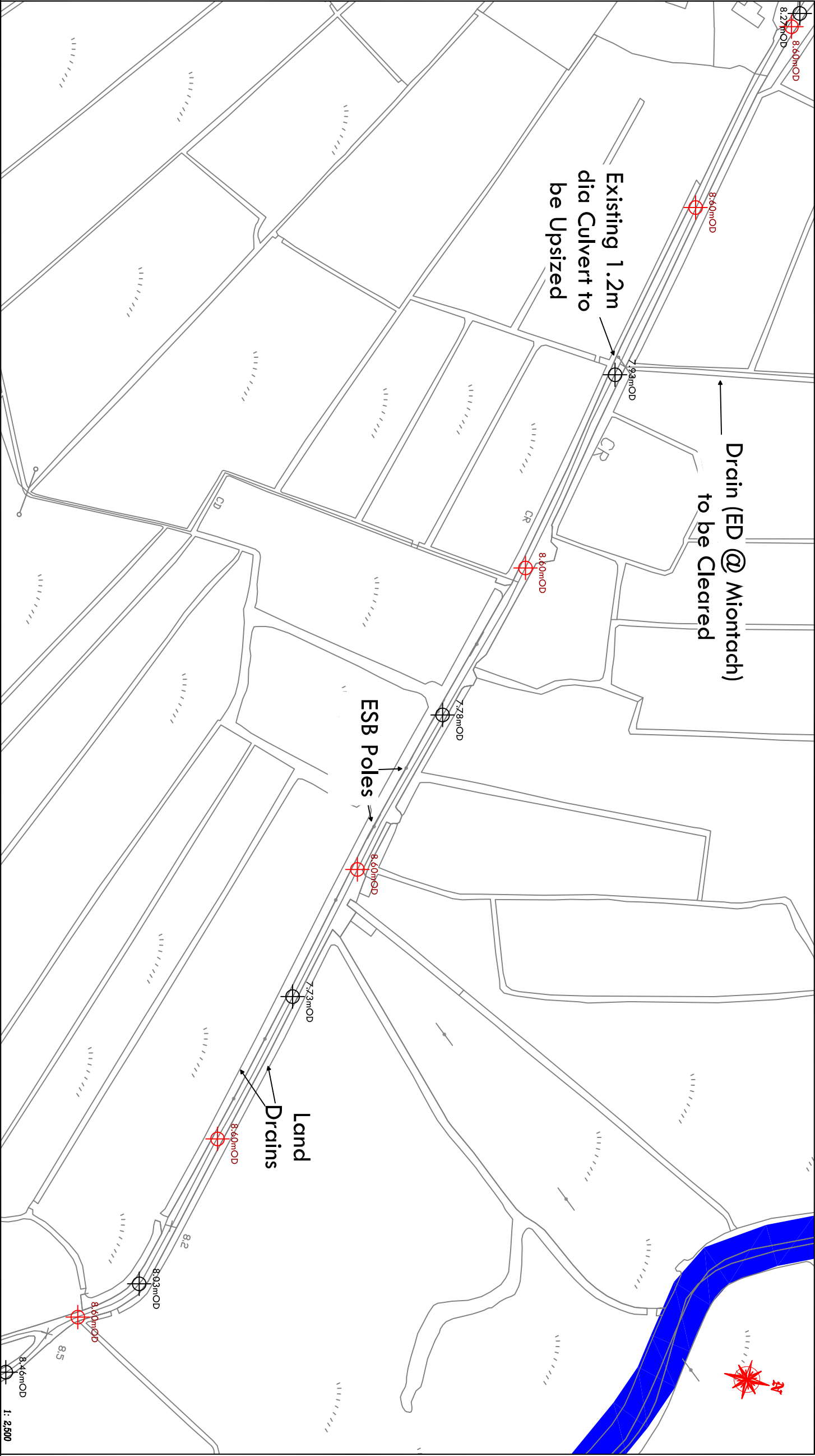

REV	DATE	DRN	DESCRIPTION	CHK	APD

Copyright Ryan Hanley
This drawing must not be reproduced in any form without the prior written consent of Ryan Hanley consulting engineers

DRAWING STATUS

<input type="checkbox"/> PRELIMINARY	<input type="checkbox"/> CONTRACT	<input type="checkbox"/> DESIGN
<input type="checkbox"/> PLANNING	<input type="checkbox"/> CONSTRUCTION	<input type="checkbox"/> PRO APPROVAL
<input checked="" type="checkbox"/> FOR YOUR INFORMATION	<input type="checkbox"/> AS CONSTRUCTED	<input type="checkbox"/> ISSUED

RYAN HANLEY
CONSULTING ENGINEERS
Sherwood House, Sherwood Avenue
Taylor's Hill, Galway
Tel: 091 1587116 Fax: 091 1587110
Email: rhc@ryanhaley.ie
Web: www.ryanhaley.ie

CLIENT
Office of Public Works

PROJECT
Clare River Flood Study

TITLE
**Measures 2a and 2b
Outline Design**

SCALE @ A3
As Shown

DATE	DRAWN	CHECKED	APPROVED
JUNE 2010	R.K.	C.L.	M.J.

JOB NO. 2138 **DRAWING NO.** Sketch 2.1 **REV.**

NOTES

1. Note road has already been raised above field levels, with deep drains on either side. Health and Safety measures will need to be put in place, e.g. crash barriers.

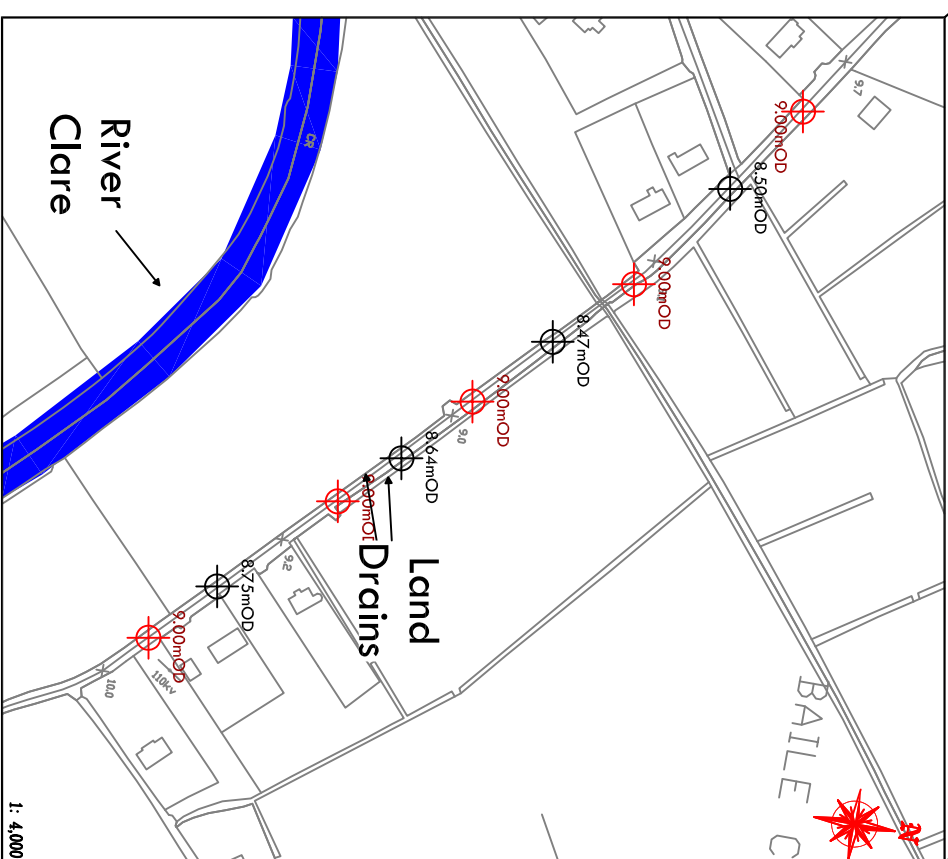
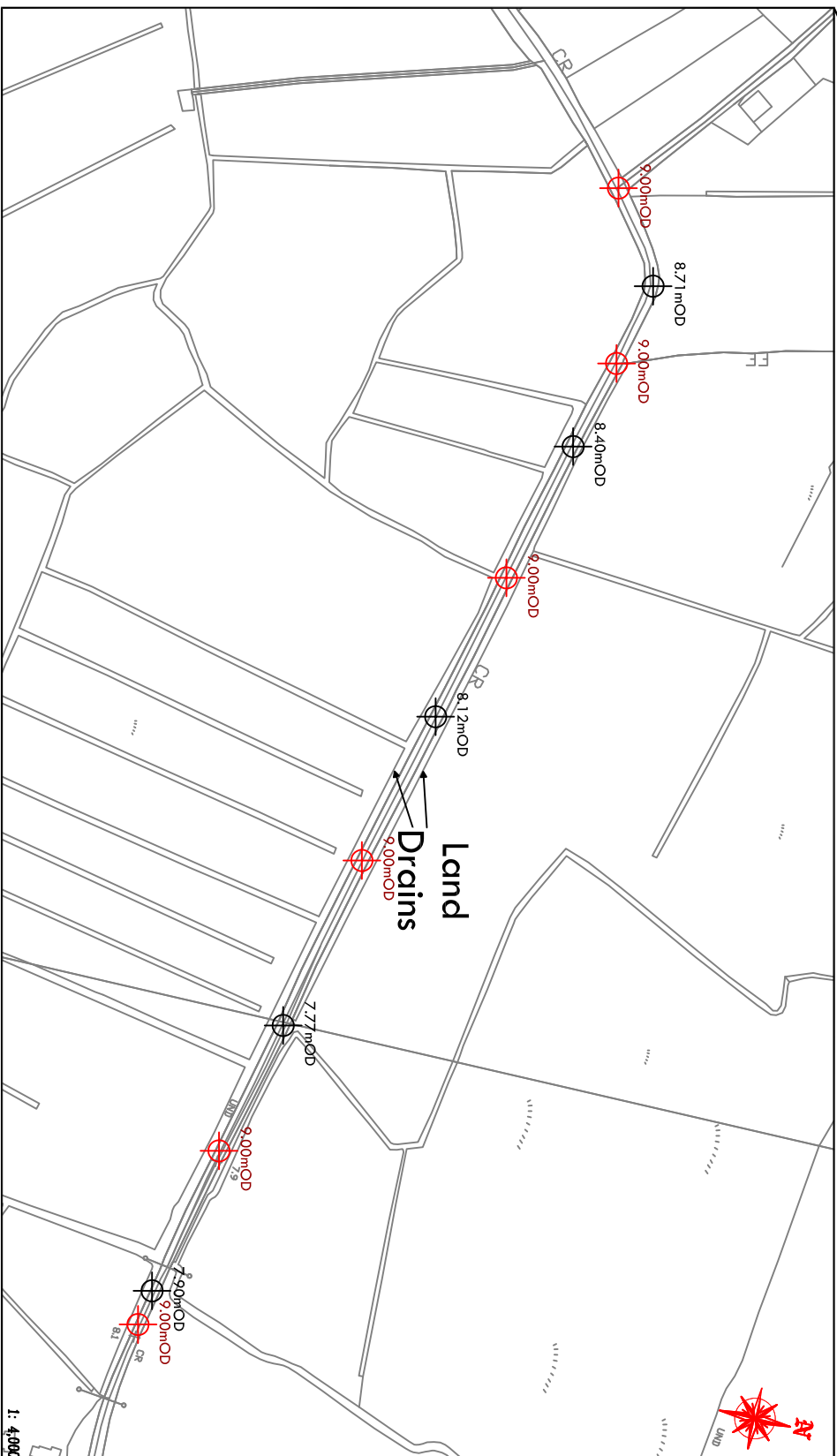
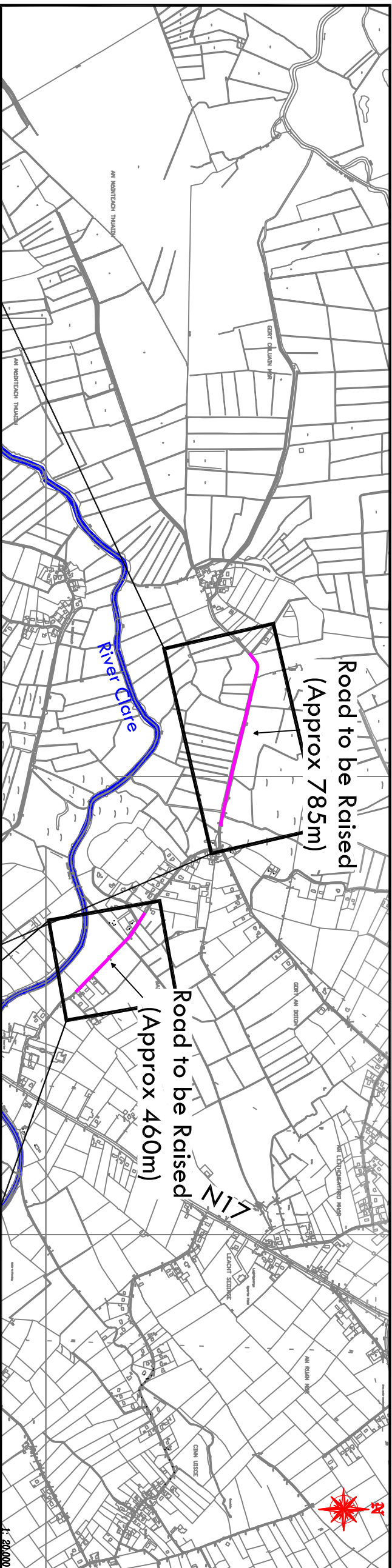

REV	DATE	DRN	DESCRIPTION	CHK	APP
REVISIONS					
Copyright Ryan Hanley This drawing was produced in my firm without the prior written consent of Ryan Hanley consulting engineers					
DRAWING STATUS <input type="checkbox"/> PRELIMINARY <input type="checkbox"/> CONTRACT <input type="checkbox"/> TENDER <input type="checkbox"/> PENDING <input type="checkbox"/> CONSTRUCTION <input type="checkbox"/> FOR APPROVAL <input checked="" type="checkbox"/> FOR YOUR INFORMATION <input type="checkbox"/> AS CONSTRUCTED <input type="checkbox"/> DRAFT					
<div style="display: flex; justify-content: space-between;"> <div> PROJECT Clare River Flood Study </div> <div>  RYAN HANLEY CONSULTING ENGINEERS Sherwood House, Sherwood Avenue Taylor's Hill, Glenroy Tel: (09) 1957 1116 Fax: (09) 1957 1110 Email: info@ryanhaley.co.nz www.ryanhaley.co.nz </div> </div>					
CLIENT DBSUN OFFICE, State Of, The Cities Offices, Beacon South Quarter, Sandford, Dunedin					
TITLE <div style="display: flex; justify-content: space-between;"> <div> SCALE @ A3 As Shown </div> <div> DATE JUNE 2010 </div> <div> DRAWN R.K. </div> <div> CHECKED C.L. </div> <div> APPROVED M.J. </div> </div> <div style="display: flex; justify-content: space-between; margin-top: 10px;"> <div> JOB No. 2138 </div> <div> DRAWING No. Sketch 31 </div> <div> REV. </div> </div>					

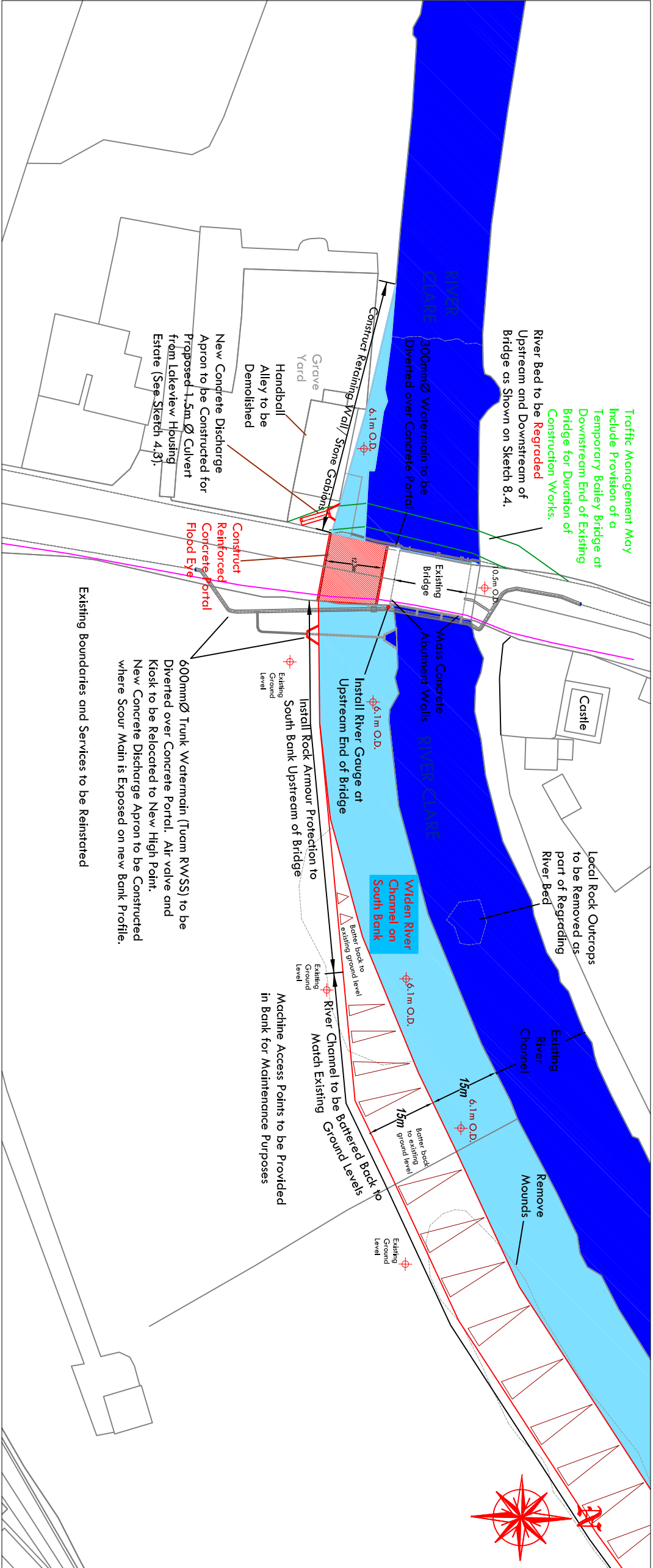

Plan View of Claregalway Bridge Scale 1:1,000

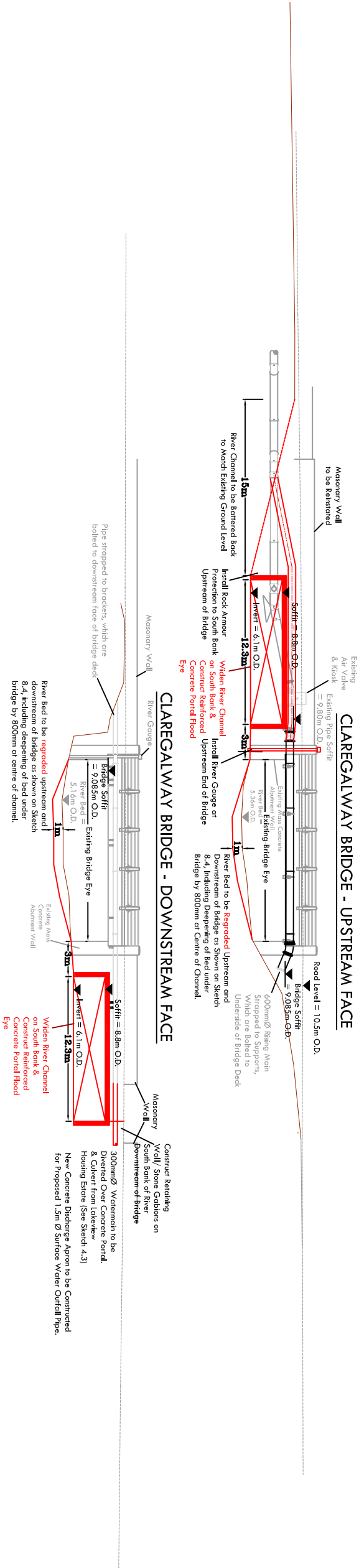

East & West Elevations of Claregalway Bridge Scale 1:250

COPYRIGHT Ryan Hanley This drawing is the property of Ryan Hanley and is not to be reproduced in any form without the prior written consent of Ryan Hanley consulting engineers.			
DRAWING STATUS <input type="checkbox"/> PRELIMINARY <input type="checkbox"/> PLANNING <input checked="" type="checkbox"/> FOR YOUR INFORMATION <input type="checkbox"/> CONTRACT <input type="checkbox"/> CONSTRUCTION <input type="checkbox"/> AS CONSTRUCTED <input type="checkbox"/> TENDER <input type="checkbox"/> FOR APPROVAL <input type="checkbox"/> ASSET			
CLIENT Sherwood House, Sherwood Avenue Taylor's Hill, Galway Tel: 091 1587116 Fax: 091 1587110 Email: info@ryanhaley.ie Web: www.ryanhaley.ie			
DUBLIN OFFICE: Suite D4, The Clavis Office, Bascos South Quarter, Sandycove, Dublin 18.			
PROJECT River Clare Flood Study			
TITLE Measures 4a & 4b. Outline Design			
SCALE @ A3 AS SHOWN	DATE June 2010	DRAWN J.R.	CHECKED / APPROVED C.L. M.F.J.
JOB No. 2138	DRAWING No. Sketch 4.2		REV.

- Proposed Culvert
- Proposed Field Drain
- Proposed Embankment

Copyright Ryan Hanley

It is acknowledged to any form without the prior written consent of Ryan Hanley consulting engineers

DRAWING STATUS

☐ PRELIMINARY
☒ PLANNING
☒ FOR YOUR INFORMATION

☐ CONTRACT
☐ CONSTRUCTION
☐ AS CONSTRUCTED

☐ TENDER
☐ FOR APPROVAL
☐ ASUILT

RYAN HANLEY

CONSULTING ENGINEERS

Sherwood House, Sherwood Avenue

Taylor's Hill, Galway

Tel:0911587716 Fax:0911587110

Email: mc@ryanhaley.ie

Web: www.ryanhaley.ie

DUBLIN OFFICE: Suite D4, The Cullis Offices, Balcoun South Quarter, Sandycove, Dublin18.

CLIENT

Office of Public Works

PROJECT

River Clare Flood Study

TITLE

Measures 4c, 4d & 6a

Outline Design

SCALE @ A3

AS SHOWN

JOB NO. 2138

DATE June 2010

DRAWN J.R.

DRAWING NO. Sketch 4.3

CHECKED C.L.

APPROVED M.F.J

REV.

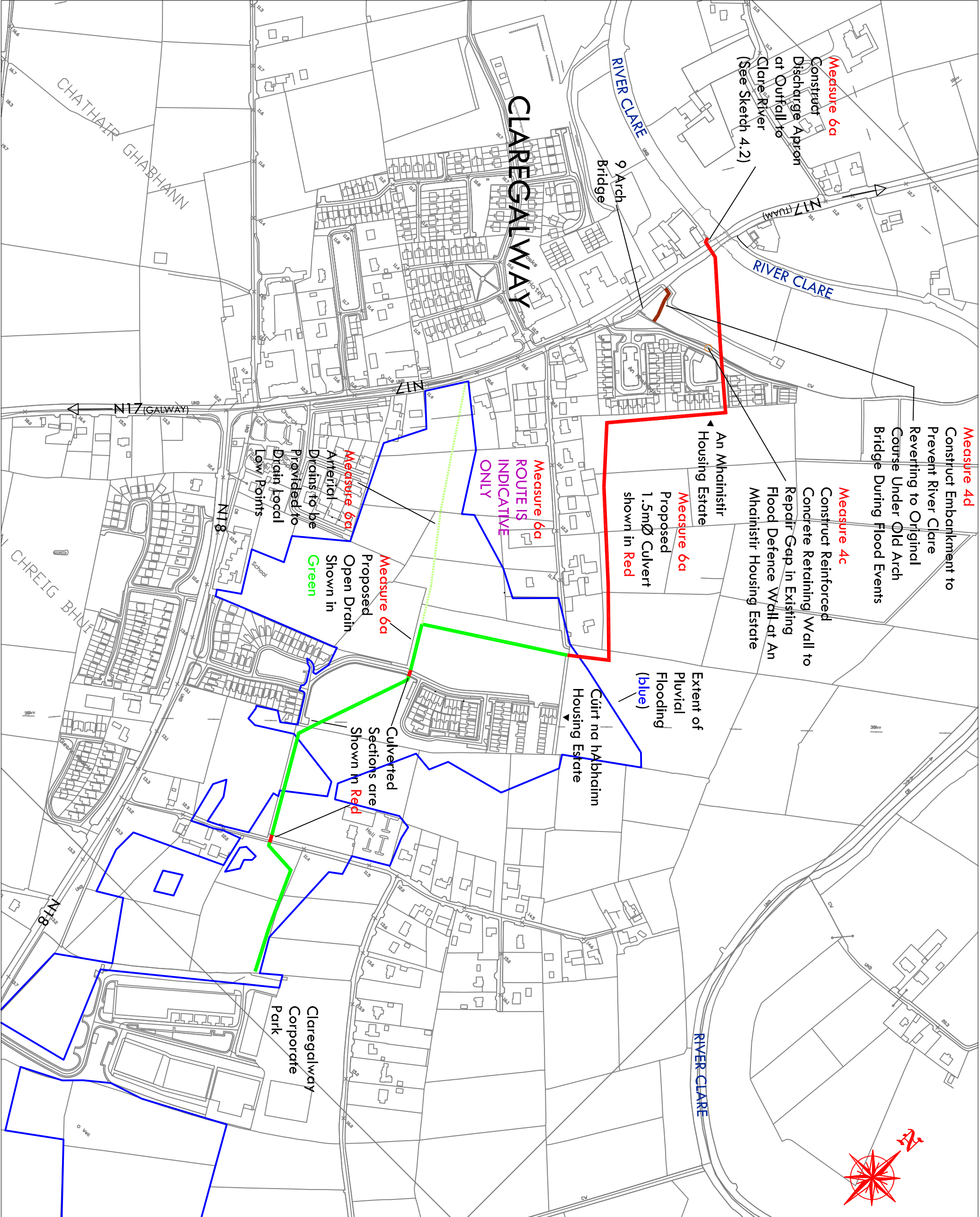

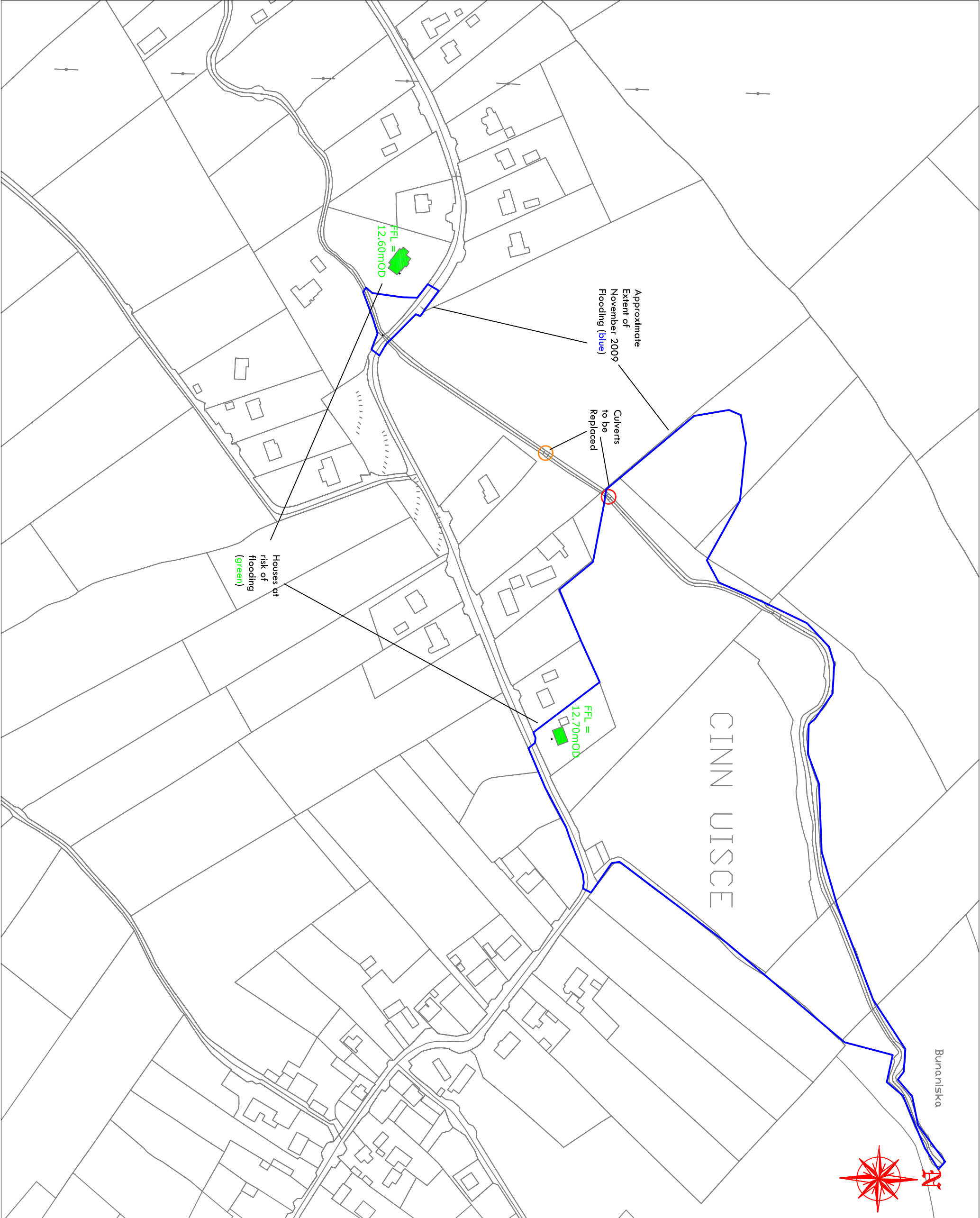

REV	DATE	DRN	DESCRIPTION	CHK	APP

REVISIONS

Copyright Ryan Hanley
This drawing is reproduced in any form without the prior written consent of Ryan Hanley consulting engineers

DRAWING STATUS

- ☐ PRELIMINARY
- ☐ CONTRACT
- ☐ FEEDER
- ☐ PLANNING
- ☐ CONSTRUCTION
- ☐ FOR APPROVAL
- ☒ FOR YOUR INFORMATION
- ☐ AS CONSTRUCTED
- ☐ ASUILT

RYAN HANLEY
CONSULTING ENGINEERS

Sherwood House, Sherwood Avenue
Taylor's Hill, Galway
Tel:091 1587716 Fax:091 1587710
Email: rhc@ryanhaley.ie
Web: www.ryanhaley.ie

DUBLIN OFFICE: Suite D4, The Clucas Offices, Beacon South Quarter, Sandycove, Dublin 18.
CLIENT

Office of Public Works

PROJECT

River Clare Flood Study

TITLE

Measure 5a.
Outline Design

SCALE @ A3	DATE	DRAWN	CHECKED	APPROVED
AS SHOWN	June 2010	J.R.	C.L.	M.F.J
JOB NO.	DRAWING NO.	Sketch 5.1	REV.	
2138				

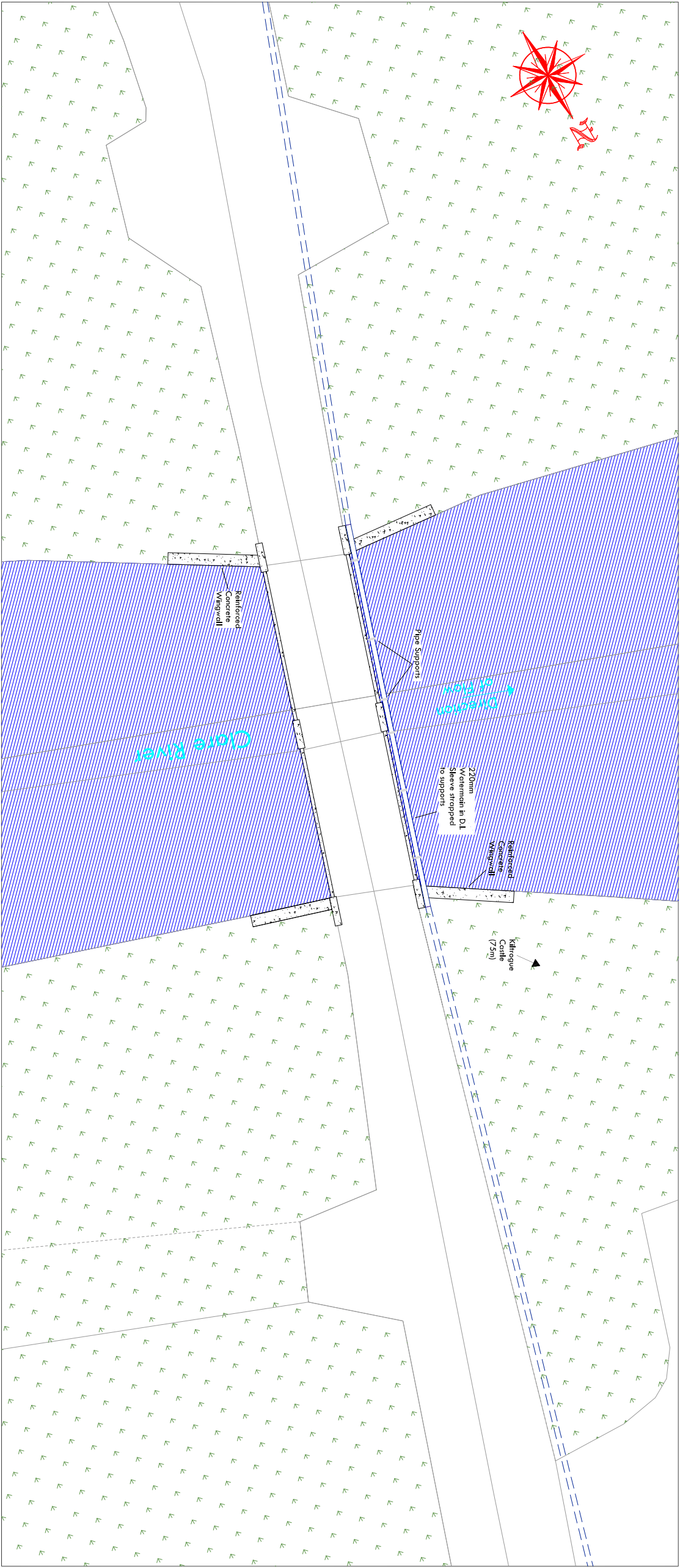

Plan View of Crusheen Bridge Scale 1:200

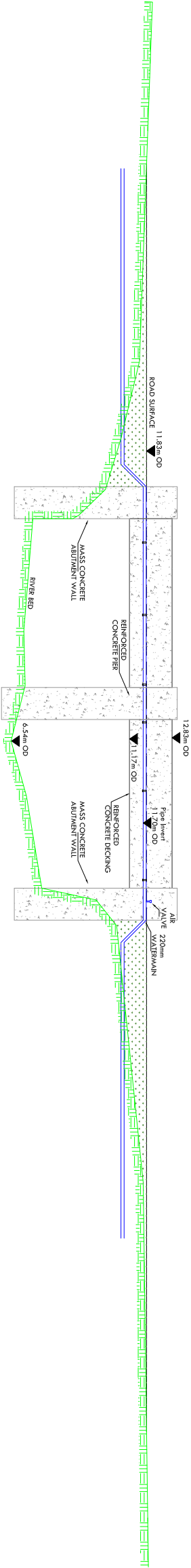

Downstream Face 1:200

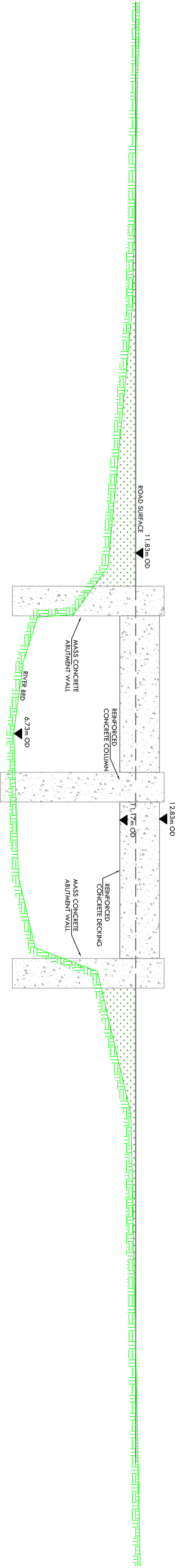

Upstream Face 1:200

NOTES

REV	DATE	DRN	DESCRIPTION	CHK	APP

REVISIONS

Copyright Ryan Hanley
This drawing must not be reproduced in any form without the prior written consent of Ryan Hanley consulting engineers

DRAWING STATUS

- ☐ PRELIMINARY
- ☐ CONTRACT
- ☐ TENDER
- ☒ PLANNING
- ☐ CONSTRUCTION
- ☐ FOR APPROVAL
- ☒ FOR INFORMATION
- ☐ AS CONSTRUCTED
- ☐ DRAFT

RYAN HANLEY

CONSULTING ENGINEERS

Shenwood House, Shenwood Avenue

Taylor's Hill, Galway

Tel: 091 827116 Fax: 091 827110

Email: info@ryanhaley.ie

Web: www.ryanhaley.ie

DUBLIN OFFICE: Suite 04, The Colson Office, Barton South Quarter, Sandymount, Dublin 4

CLIENT

Office of Public Works

PROJECT

Clare River Flood Study

TITLE

**Plan View & Elevation of
Existing Crusheen Bridge**

SCALE @ A3	DATE	DRAWN	CHECKED	APPROVED
As Shown	JUNE 2010	R.K.	C.L.	M.J.

JOB No.	DRAWING No.	REV.
2138	Sketch 8.1	

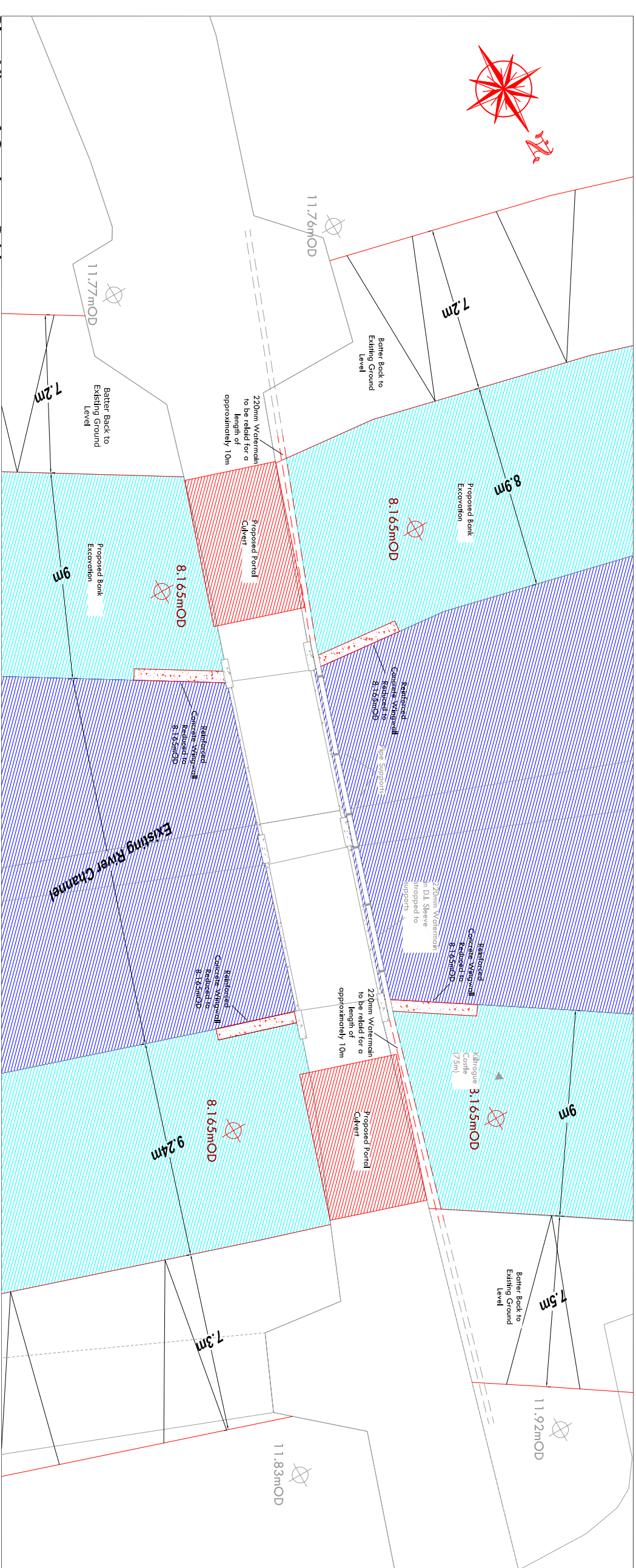

Plan View of Crusheen Bridge Scale 1:200

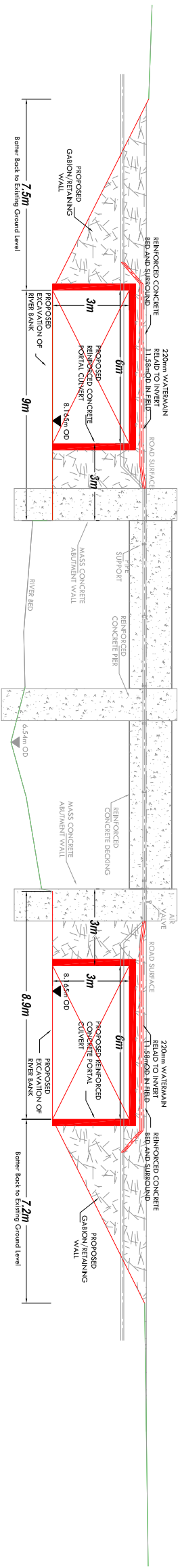

Downstream Face 1:200

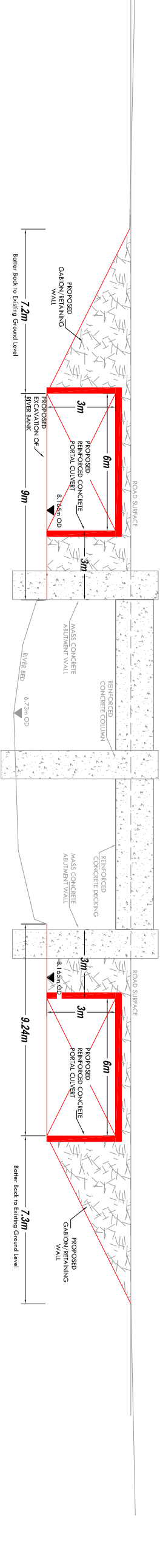

Upstream Face 1:200

- NOTES
- Culvert invert level set at higher level than existing bed so as to maintain existing low flow conditions.
 - Crusheen Bridge will be closed for two weeks during construction phase. A diversion for local traffic will be put in place.
 - Temporary water supply may be required while watermain is being diverted
 - Works will be carried out in the vicinity of a Candidate Special Area of Conservation.

REV	DATE	DRN	DESCRIPTION	CHK	APP
REVISIONS					

Copyright Ryan Hanley
This drawing must not be reproduced in any form without the prior written consent of Ryan Hanley consulting engineers

DRAWING STATUS			
<input type="checkbox"/> PRELIMINARY	<input type="checkbox"/> CONTRACT	<input type="checkbox"/> TENDER	
<input type="checkbox"/> PLANNING	<input type="checkbox"/> CONSTRUCTION	<input type="checkbox"/> WORK APPROVAL	
<input checked="" type="checkbox"/> FOR YOUR INFORMATION	<input type="checkbox"/> AS CONSTRUCTED	<input type="checkbox"/> DEPART	

RYAN HANLEY

CONSULTING ENGINEERS

Sherwood House, Sherwood Avenue

Taylor's Hill, Galway

Tel:091937116 Fax:091937110

Email: rhc@ryanhaley.ie

Web: www.ryanhaley.ie

DUBLIN OFFICE: Suite D4, The Glass Office, Beacon South Quarter, Smockfield, Dublin 8.

Office of Public Works

PROJECT

Clare River Flood Study

TITLE

Measure 8a - Outline Design

SCALE @ A3	DATE	DRAWN	CHECKED	APPROVED
As Shown	JUNE 2010	R.K.	C.L.	M.J.
JOB No.	DRAWING No.	Sketch 8.2		REV.
2138				